

DH123 CONSTRUCTION A

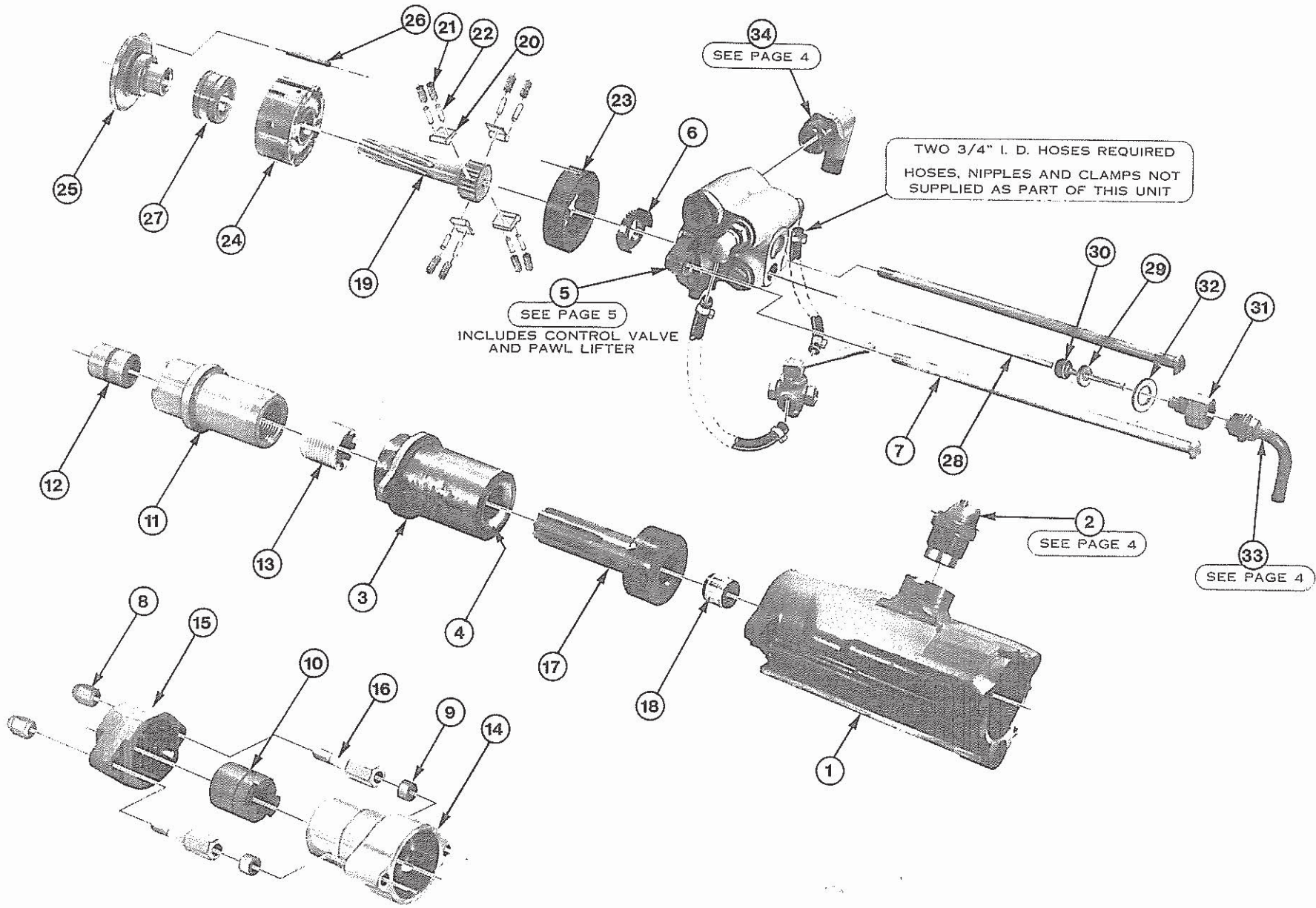

DH123
CONSTRUCTION **A**

DH123 PARTS LIST

- Cylinder with stellite ways and top exhaust
- Remote Control Dual Backhead
- Rifle Bar Rotation ● Remote Reversible Rotation Direction Control
- Chuck for 1-1/2" Rd. x 3-13/16" Tangential Lug Shanks
- 7/16" Dia. Steel Tube ● Wet-or-Dry Swivel
- Bolted-on Chuck End Cap

REF. NO.	PART NUMBER	DESCRIPTION	REF. NO.	PART NUMBER	DESCRIPTION
1	1DH231D	Cylinder Assembly Complete - Includes Exhaust Deflector	18	DH12310A36	Rifle Nut
2	1039046	Exhaust Deflector Assembly - See Page 4 for component parts	19	DH1231136	Rifle Bar
3	DH1231BX	Cylinder Sleeve - Includes Liner	20	1711A	Pawl - 4 required
4	DH1231L	Cylinder Liner	21	S5511C	Pawl Spring - 8 required
5	1DH23311X	Backhead Assembly - See Page 5 for component parts	22	CF73H11B	Plunger - 8 required
6	1DH23571	Pawl Lifter	23	DH123133D	Pawl Ring
7	DH1233A	Side Rod - 2 required	24	1PR2315	Valve Chest
8	CF793N	Nut - 2 required	25	DH12315B	Valve Plug
9	CF793S	Spacer - 2 required	26	DH12315D	Valve Chest Pin
10	DH1237CR	Chuck - for 1½" Rd. x 3-13/16" Tangential Lug Shanks	27	DH12316	Automatic Valve
11	DH1237EJ	Chuck Driver	28	1DH2327	Tube - 7/16" Plastic
12	17L7CR	Chuck Sleeve Bushing - 1½" Rd. x 3-13/16"	28	1DH2327A	Tube - 5/16" Plastic
13	DH1237NC	Chuck Driver Nut	28	1DH2327B	Tube - 7/16" Steel
14	1DH2317A	Chuck End	28	1DH2327C	Tube - 5/16" Steel
15	1028292	Chuck End Cap - 1½" Dia. Shanks.	29	DH12339D	Tube Washer
16	1028636	Adapter - 2 required	30	DH12329B	Tube Gasket
17	DH1239HA	Hammer	31	DH12313C	Spud
			32	S481W	Washer
			33	6MCT0T3Z	Swivel Connection Assembly - See Page 4 for component parts
			34	DH123147X	Air Connection Tube Assembly - See Page 4 for component parts

AIR CONNECTION

DH123147X
AIR CONNECTION TUBE ASSEMBLY

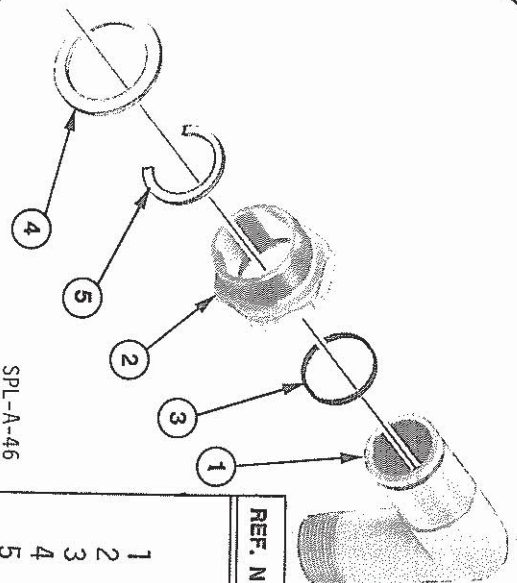

SPL-A-46

REF. NO.	PART NUMBER	DESCRIPTION
	DH123147X	Air Connection Tube Assembly - Consists of the following parts:
1	DH123147	Air Connection Tube
2	DH123146	Swivel Spud - Includes O Ring
3	OG1	O Ring
4	CF99146W	Washer
5	DH123149	Retainer Ring

EXHAUST DEFLECTOR

1039046
EXHAUST DEFLECTOR ASSEMBLY

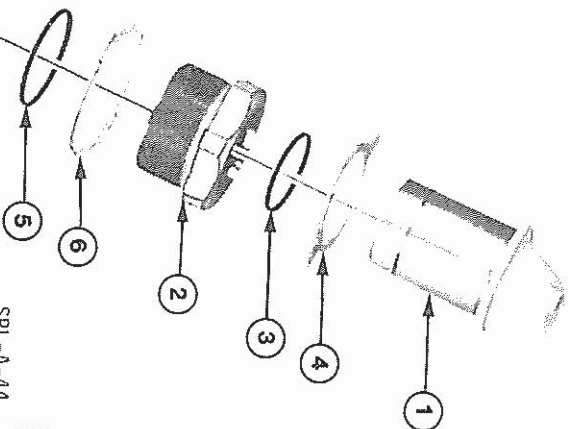

SPL-A-44

REF. NO.	PART NUMBER	DESCRIPTION
	1039046	Exhaust Deflector Assembly - Consists of the following parts:
1	1DH23347	Exhaust Deflector
2	DH143146P	Swivel Spud Assembly - Includes O Ring
3	OR33	O Ring
4	1039010	Lockwasher
5	1039050	Retaining Ring
6	DH143146T	Lockwasher

AIR OR WATER CONNECTION

6MC1013Z
AIR OR WATER CONNECTION TUBE ASSEMBLY

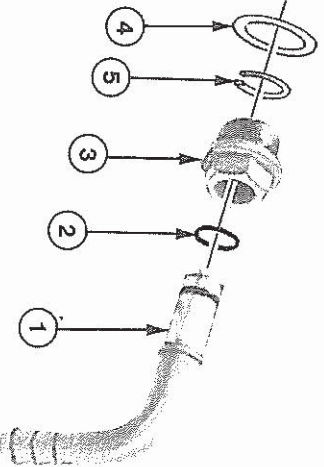

SPL-A-45

REF. NO.	PART NUMBER	DESCRIPTION
	6MC1013Z	Air Connection Tube Assembly - Consists of the following parts:
1	6MC1013	Air Connection Tube - Includes O Ring
2	OR13	O Ring
3	DH9913D	Swivel Spud
4	DH9913E	Washer
5	DH9913R	Retainer Ring

REMOTE ROTATION BACKHEAD

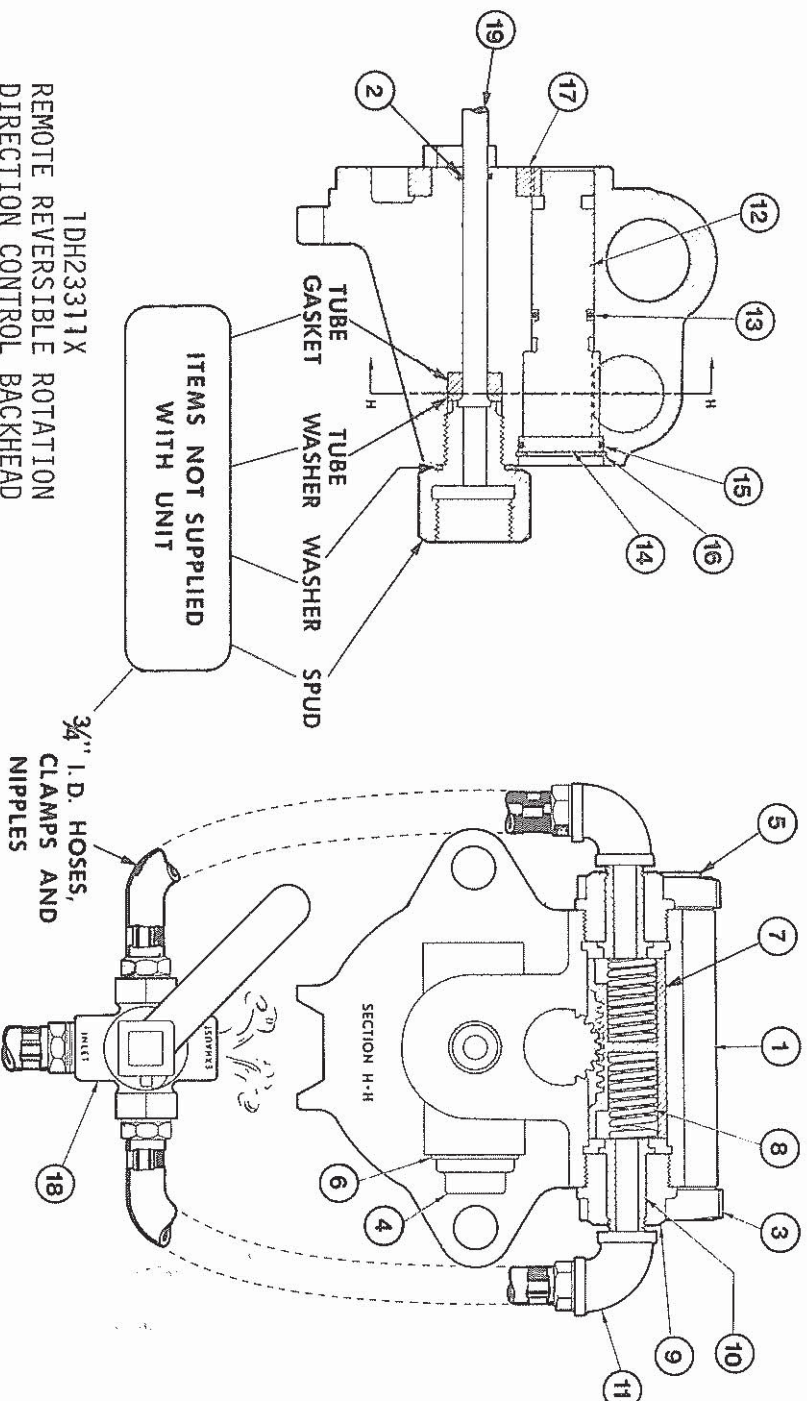

1DH23311X
 REMOTE REVERSIBLE ROTATION
 DIRECTION CONTROL BACKHEAD

3/4" I.D. HOSES,
 CLAMPS AND
 NIPPLES

REF. NO.	PART NUMBER	DESCRIPTION
	1DH23311X	Backhead Assembly Complete - Consists of the following parts:
1	1DH232X	Backhead Assembly - Includes the next 6 parts:
2	OR9	0 Ring
3	DH123D146	Bushing - 2 required
4	S481P	Plug
5	PP7A	pipe Plug
6	S481W	washer
7	SF4	Gear Rack
8	SF4H	Spring - 2 required
9	SF7	Swivel Spud - 2 required
10	SF97	Air Connection Tube - 2 required
11	PL7	Standard Elbow - 2 required
12	1DH23726	Control Shaft - Includes 0 Ring
13	OR17	0 Ring
14	1DH23602	Bearing Plate - Includes 0 Ring
15	ORS28	0 Ring
16	TRR33	Retaining Ring
17	1DH23571	Pawl Lifter
18	1028494	Control Valve
19	1DH2327	Tube - 7/16" Plastic
19	1DH2327A	Tube - 5/16" Plastic
19	1DH2327B	Tube - 7/16" Steel
19	1DH2327C	Tube - 5/16" Steel

- Cylinder with steel/lite ways and top exhaust
- Remote Control Dual Backhead
- Rifle Bar Rotation
- Chuck for 1-1/2" Rd. x 3-13/16" Tangential Lug Shanks
- 7/16" dia. Steel Tube
- Bolted-on Chuck End Cap
- Integral Reversible Rotation Direction Control
- Wet-or-Dry Swivel

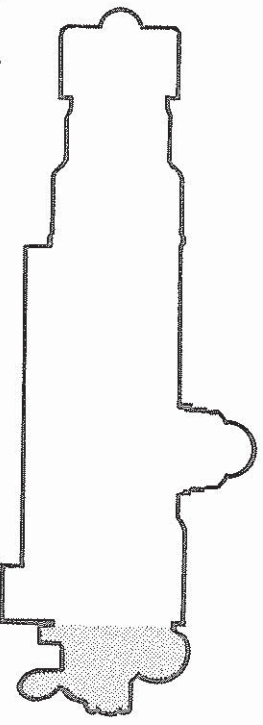

Common repair parts for DH123 Drills are fully illustrated on pages 2 and 3. The following parts are used in this construction to make it an Integral Reversible Rotation Direction Control.

REF. NO.	PART NUMBER	DESCRIPTION
5	DH123D2DY	Backhead Assembly - See below for component parts
6	DH99134	Pawl Lifter
28	DH12327G DH9913X	Air Tube - 7/16" Steel Water Connection Assembly-See page 7 for component parts

MANUAL ROTATION BACKHEAD

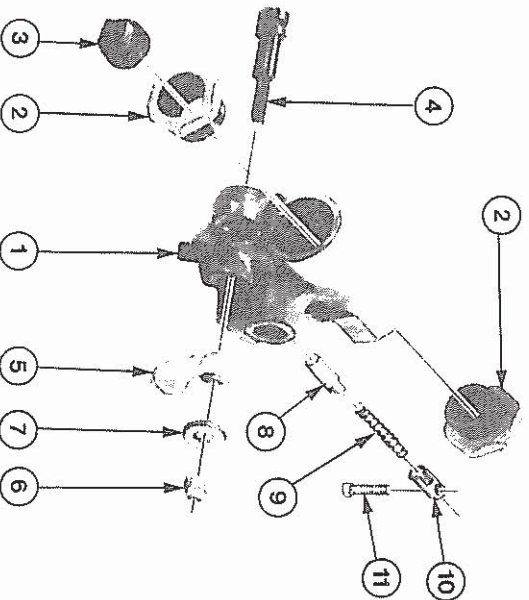

DH123D2DY
INTEGRAL REVERSIBLE ROTATION
DIRECTION CONTROL BACKHEAD

REF. NO.	PART NUMBER	DESCRIPTION
1	DH123D2DY	Backhead Assembly Complete -
2	1028516	Consists of the following parts: Backhead Assembly - Includes two Spuds and one Pipe Plug
3	DH123D146	Spud - 2 required
4	PP7	Pipe Plug
5	DH99135	Control Shaft
6	DH99136	Control Handle
7	SF86N	Nut
8	WP20	Lockwasher
9	CF892D	Detent
10	AF8982	Spring
11	DH992R SF2P	Retainer Pin

SPL-B-104

WATER CONNECTION TUBE

DH9913X WATER CONNECTION TUBE ASSEMBLY

REF. NO.	PART NUMBER	DESCRIPTION
	DH9913X	Water Connection Tube Assembly - Consists of the following parts:
1	10713C	Spud
2	10713G	Gasket
3	D9313T	Water Connection Tube - Includes 0 Ring
4	OR10	0 Ring
5	D9313D	Swivel Spud
6	D9313E	Washer
7	D9313R	Retainer Ring
8	1047092	Air Hose - 1/2" I.D. x 12" Long
9	SHC62KC	Hose Nipple
10	BDT3	Hose Clamp - 2 required
11	PS6	Street Elbow - 2 required
12	CF9947X	Valve Assembly

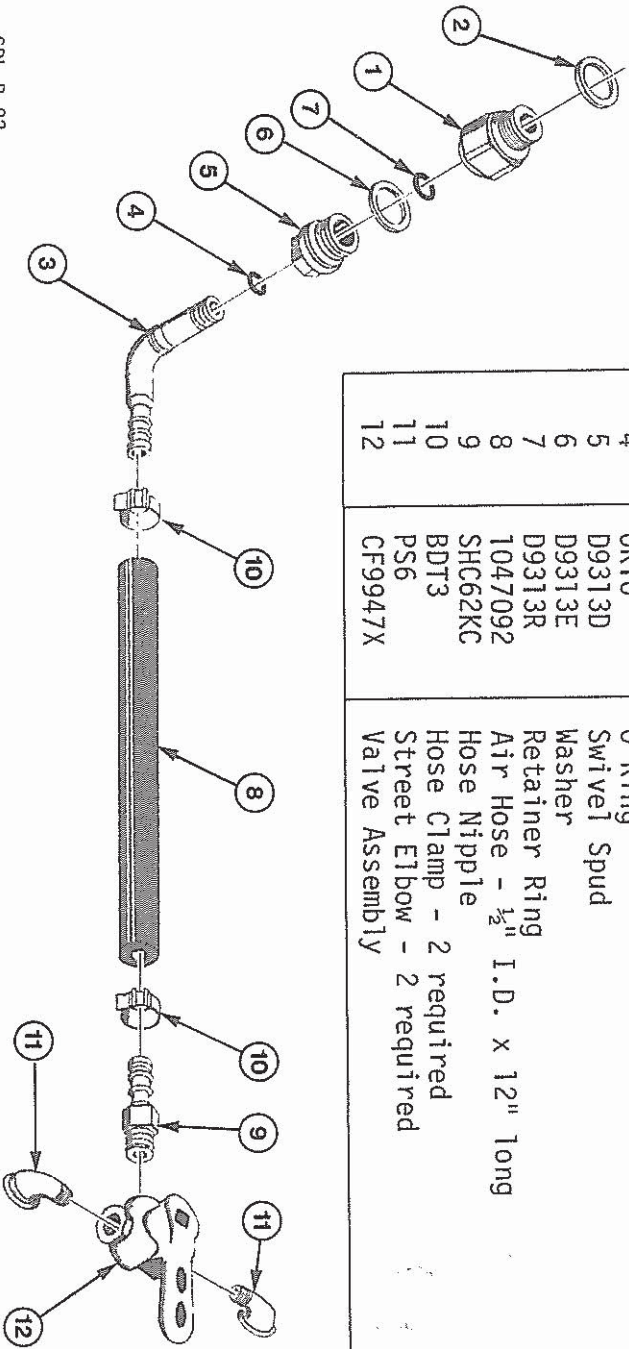

SPL-B-92

**DULL OR BROKEN
BITS CAUSE
POOR DRILLING**

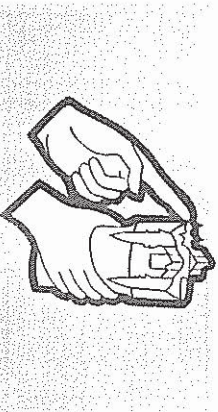

**KEEP HOSES OUT
OF THE MUCK**



ADDITIONAL EQUIPMENT

Items described below are available for use with the DH123 Drifter Drill. Contact a Gardner-Denver Sales Office for price and delivery information.

- 1PR231B Cylinder Assembly Complete - Cylinder with plain ways and top exhaust
- 1DH231 Cylinder Assembly Complete - Cylinder with stellite ways and side exhaust
- 1030786 Exhaust Swivel Tube - For use on top exhaust cylinders
- 1029439 Silencer Assembly - 20 ft. Hose - See Below
- 1032933 Silencer Assembly - 35 ft. Hose - See Below
- 1048400 Neoprene Muffler
- 1D9313X Swivel Connection Tube - with 120° angle for 1/2" I.D. Hose
- D9313TX Swivel Connection Tube - with 90° angle for 1/2" I.D. Hose
- 1DH23786 Spud - Wet-or-Dry - for use with 1D9313X and D9313TX
- 6MC1013Z Swivel Connection Tube - with 90° angle for 3/4" I.D. Hose
- DH12313C Spud - Wet-or-Dry - for use with 6MC1013Z
- DH12327R Tube - 7/16" Dia. Steel Tube Necked down to 5/16" dia.
- 1030782 Air Connection Swivel - Main Air Swivel with 45° angle
- DH1232DX Backhead Assembly - with throttle Valve for constant blowing
- 1DH239 Hammer - tight hammer
- DH1237DN Chuck - for 1-1/2" Rd. x 3-13/16" Tangential Lug Shanks and 1700V Threads
- DH1237DR Chuck - for 1-3/4" Rd. x 3-13/16" Tangential Lug Shanks and 1700V Threads
- 1028292 Chuck End Cap - 1-1/4" to 1-1/2" dia. Shank Threads
- 1028293 Chuck End Cap - 1-3/4" dia. Shank Threads
- 1028636 Adapter - 2 required
- 17L7CJ Sleeve Bushing - for use with 1" Shanks
- 17L7CL Sleeve bushing - for use with 1-1/4" Shanks
- 1029264 Feed Screw Nut - Use with Auxiliary Traveling Cent.
- 1029265 Feed Screw Nut - Use without Auxiliary Traveling Cent.
- 1D2317X Chuck End Conversion Kit - To convert a DT23 or DH123 Drift11 from a Tangential Lug Const. to a Fluted Front-End
 - Chuck Liner for 1 1/2" Rd. x 6" Fluted Shank
 - Biscuit-type Drift11 Rod Retainer

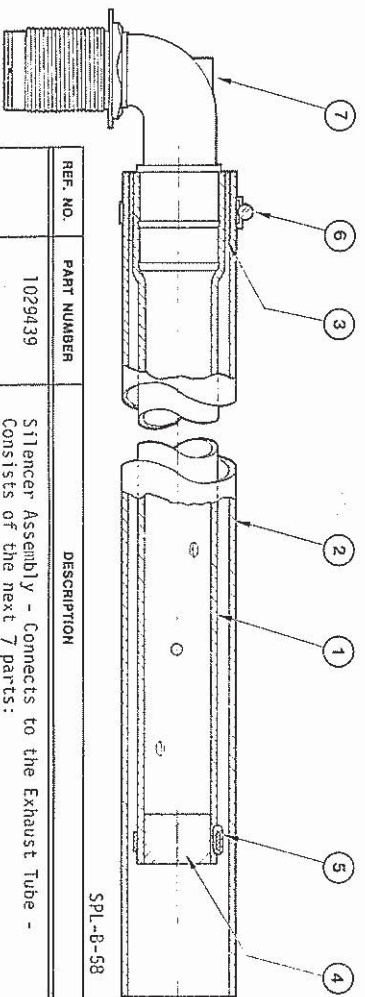
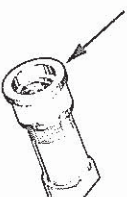
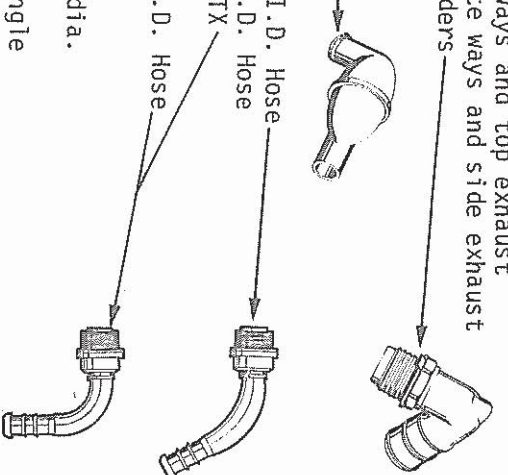

SPL-B-58

REF. NO.	PART NUMBER	DESCRIPTION
1	1029439	Silencer Assembly - Connects to the Exhaust Tube -
2	1041910	Consists of the next 7 parts:
3	1029783	Silencer Hose Assembly - Includes (1) BDT9 and (1) 1029480
4	1029480	Air Hose - 20 ft. long
5	BDT9	Spacer
6	HC48	Plug
7	1030786	Hose Clamp
		Hose Clamp
		Air Connection Tube
	1032933	Silencer Assembly - Same as 1029439 Silencer Assembly
		above except with 1032815 Hose - 35 ft. long.